

**EARTHWORK SUMMARY**

LOCATION	EXCAVATION	TRENCH	EMBANKMENT
WEST OF CUMMINGS LANE	0 CY	0 CY	40 CY
CUMMINGS TO HERMAN ESSIG DRIVE	2 CY	100 CY	984 CY
HERMAN ESSIG DRIVE TO MT. VERNON	122 CY	190 CY	332 CY
MT. VERNON TO BEARCE ENTRANCE	5 CY	90 CY	140 CY
BEARCE ENTRANCE TO OLD WALMART	11 CY	60 CY	106 CY
OLD WALMART TO GILLMAN STREET	14 CY	30 CY	22 CY
<b>TOTAL EARTH QUANTITIES</b>	<b>154 CY</b>	<b>470 CY</b>	<b>1,624 CY</b>

ESTIMATED BORROW FOR THIS PROJECT IS 1000 CY. THIS AMOUNT IS CALCULATED BY SUBTRACTING EARTH EXCAVATION AND TRENCH MATERIAL FROM EARTH EMBANKMENT. THE ESTIMATED QUANTITY OF TOPSOIL REQUIRED TO PLACE 4" OVER DISTURBED AREAS IS 910 CY. THEREFORE, ALL BORROW MATERIAL SHALL BE TOPSOIL. FURNISHING AND PLACING 4" OF TOPSOIL SHALL BE CONSIDERED INCIDENTAL TO EARTH EMBANKMENT.

\* ESTIMATED USING 6 SF OF MATERIAL GENERATED PER FOOT OF PROPOSED STORM SEWER.

\*\* A SHRINKAGE FACTOR OF 20% WAS APPLIED TO EMBANKMENT QUANTITY. ALL EMBANKMENT SHALL BE COMPACTED TO 90% STD. PROCTOR.

**LEGEND**

- 760--- EXISTING CONTOUR
- S--- EXISTING SANITARY SEWER
- S--- EXISTING STORM SEWER
- W--- EXISTING WATER MAIN
- U--- EXISTING UTILITY POLES
- S--- PROPOSED STORM SEWER

JULIE. 1-800-892-0123

- ⇨ EARTH EXCAVATION SHALL BE COMPACTED TO 90% STD. PROCTOR.
- ⇨ EARTH EMBANKMENT.
- ⇨ CONTRACTOR SHALL PLACE DANDY BAGS 1' OR EQUIV. IN ALL STREET INLETS AFTER CURB IS POURED. (2 EACH)

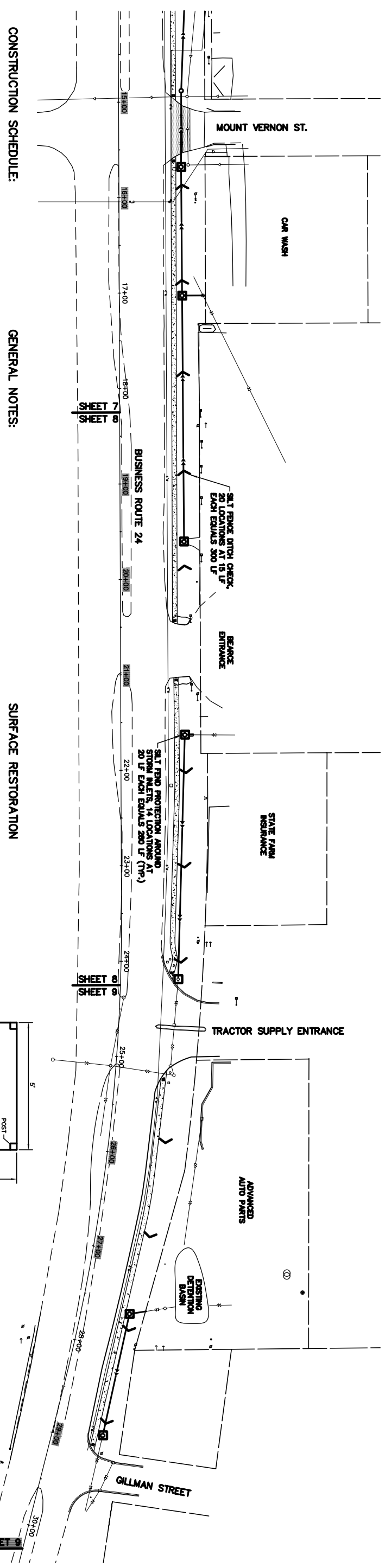
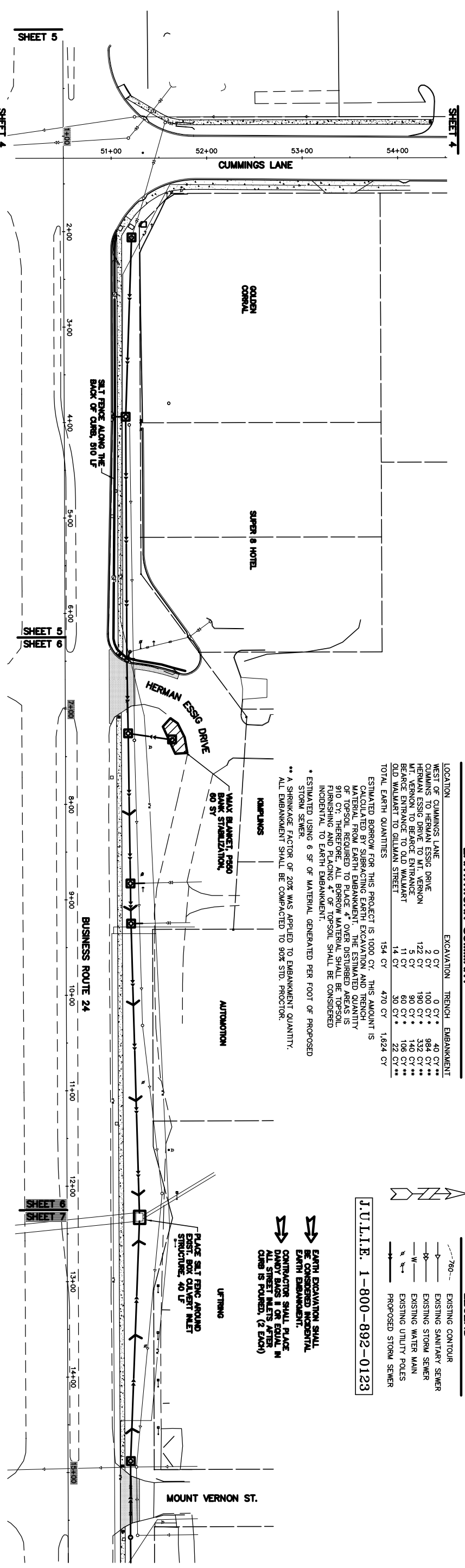

**CONSTRUCTION SCHEDULE:**

VERIFY EROSION CONTROL AND NPDES PERMIT.  
 INSTALL STORM SEWER PLACING SILT FENCE PROTECTION AROUND EACH INLET AS STORM SEWER CONSTRUCTION PROGRESSES.  
 PERFORM PAVEMENT REMOVALS, PLACE CURB AND GUTTER, AND REPLACE BITUMINOUS PAVEMENT. PLACE SILT FENCE ALONG THE BACK OF CURB AS SOON AS POSSIBLE.  
 PERFORM EMBANKMENT AND GRADING OPERATION. PLACE SILT FENCE CHECKS AS GRADING PROGRESSES.  
 PERFORM P.C. CONCRETE SIDEWALK CONSTRUCTION.  
 PERFORM FINAL GRADING OPERATION.  
 PERFORM SEEDING, FERTILIZING, AND MULCHING OPERATION.  
 REMOVE SILT FENCE WHEN GROUND COVER IS ESTABLISHED.  
 MAINTAIN NPDES RECORDS OF MAINTENANCE AND RAINFALL THROUGHOUT THE DURATION OF THE PROJECT.

**GENERAL NOTES:**

SILT FILTER FENCE AND OTHER EROSION CONTROL INSTALLATIONS SHALL BE INSPECTED BY THE CONTRACTOR WEEKLY AND AFTER HEAVY RAINS. ANY SEDIMENT BUILDUP SHALL BE REMOVED FROM THE FENCE AND ANY DAMAGE TO THE SILT FENCE SHALL BE REPAIRED BY THE CONTRACTOR AT HIS EXPENSE.  
 THE EROSION CONTROL INSTALLATION SHALL REMAIN IN PLACE & BE MAINTAINED BY THE CONTRACTOR UNTIL ALL OF THE PERMANENT GROUND COVER HAS BEEN ESTABLISHED & THE PROJECT HAS BEEN ACCEPTED BY THE CITY OF WASHINGTON EROSION CONTROL ADMINISTRATOR. THE EROSION CONTROL INSTALLATIONS SHALL THEN BE REMOVED BY THE CONTRACTOR.  
 REMOVE ANY MATERIAL TRACKED ONTO PUBLIC ROADWAYS WITHIN 4 HOURS OR AT END OF DAY, WHICHEVER IS LESS.  
 PROVIDE DUST CONTROL BY WATERING OR OTHER MEANS, AS REQUIRED.  
 SEEDING, FERTILIZING AND MULCHING SHALL BE DONE IN ACCORDANCE WITH THE STANDARD SPECIFICATIONS FOR ROAD AND BRIDGE CONSTRUCTION OF THE STATE OF ILLINOIS, CURRENT EDITION.

**SURFACE RESTORATION**

ALL DISTURBED AREAS SHALL BE GRADED TO THE PROPOSED FINISHED GRADE AND SHALL BE SEED, FERTILIZED AND MULCHED AS PER THE STANDARD SPECIFICATIONS AND THE CONTRACT SPECIFICATIONS, USING THE FOLLOWING MIXTURES AND/OR RATES:  
 THE FERTILIZER SHALL BE APPLIED AT THE RATE OF 270 LBS. OF NUTRIENTS PER ACRE AT THE NUTRIENT RATION OF 1-1-1 OF NITROGEN, PHOSPHORUS, AND POTASSIUM.  
 THE SEED SHALL BE SOWN AT THE RATE OF 150 LBS. PER ACRE OF A MIXTURE COMPOSED OF 30 LBS. KENTUCKY 30, 30 LBS. ALTA FESCUE, 20 LBS. PERENNIAL RYE GRASS, 20 LBS. CREEPING RED FESCUE AND 50 LBS. SPRING OATS.  
 STRAW MULCH SHALL BE APPLIED AT THE RATE OF 2 TONS PER ACRE AND SHALL BE ANCHORED IN PLACE USING A MECHANICAL STABILIZER OR BY BLOWING ON EMULSIFIED ASPHALT COATED MULCH. IF THE EMULSIFIED ASPHALT METHOD IS USED, THE RATE SHALL BE 75 GALLONS PER TON.

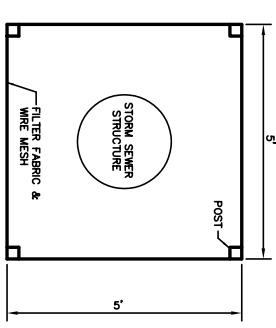

NOTE: PROVIDE SILT FENCE EROSION PROTECTION AROUND STORM SEWER STRUCTURES AS SOON AS POSSIBLE AFTER STORM SEWER INSTALLATION.

**OVERALL LAYOUT AND EROSION CONTROL PLAN**

FOR: CITY OF WASHINGTON  
 DATE: 10/8/08  
 SCALE: 1" = 50'  
 PROJECT: BUSINESS ROUTE 24 DRAINAGE IMPROVEMENTS  
 NORTH SIDE FROM CUMMINGS LANE TO GILLMAN STREET  
 AUSTIN ENGINEERING CO., INC.  
 CIVIL ENGINEERS  
 LICENSE NO. 194-001148  
 DRAWN BY: [Signature]  
 CHECKED BY: [Signature]  
 SHEET NO. 2 OF 15